

Safe Spaces Soton

John Hansard Gallery, in partnership with Skate Southampton, presents Safe Spaces Soton. This new initiative seeks to encourage the reactivation of seemingly forgotten 'in-between' areas of the city, aiming to stir community imagination towards the reclamation of dormant civic spaces. We invited Southampton photographer Luke Shears to take photographs of the local area and have placed these images inside and outside of community spaces in Northam, St. Mary's and Guildhall Square.

We would like you to feel inspired and imagine how you can change these "in between" spaces into social and safe places for all to enjoy. It is about having open conversations around community empowerment and how people can feel ownership of their local environments and create dynamic, inclusive, safe civic spaces for all to celebrate and enjoy.

Take part. Share your vision with us. Follow **SafeSpaceSoton** on Instagram and tag your posts **#SafeSpacesSoton** or **#JHGCommunity** to have your ideas featured and get your voice heard!

Safe Spaces Soton is part of John Hansard Gallery's Community Takeover programme for 2020. Find out more at **www.jhg.art**.

John
Hansard
Gallery

UNIVERSITY OF
Southampton



Supported using public funding by
**ARTS COUNCIL
ENGLAND**



**SKATE
SOUTHAMPTON**

SSS

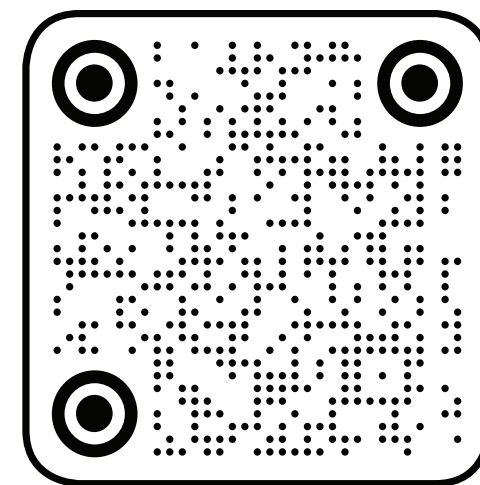



Tactical Urbanism



Tactical urbanism includes low-cost, temporary changes to the built environment, usually in cities, intended to improve local neighbourhoods and city gathering places.

Humanising Public Spaces

Community Take Over – SafeSpacesSoton

Take part:

We are inspired by the local skateboarding community, which is well known for finding new ways to change spaces. Their “do it yourself” attitude has led to new social and positive spaces.

- Share your vision
- Can you think of ways to bring new life to Southampton’s “in between” or forgotten spaces?
- How would you change places to make them welcoming to all?
- What would you improve to make you feel safer?
- What kind of outdoor event or activity can you imagine happening in your neighbourhood that could bring people of different ages and backgrounds together?

Join in. Share your own photographs of an unused space near you. Describe how you would change this space. Draw, paint or collage or find images that reflect your ideas.

Be part of the conversation.

Follow SafeSpaceSoton on Instagram and tag your posts **#SafeSpacesSoton** or **#JHGCommunity** to have your ideas featured and get your voice heard!

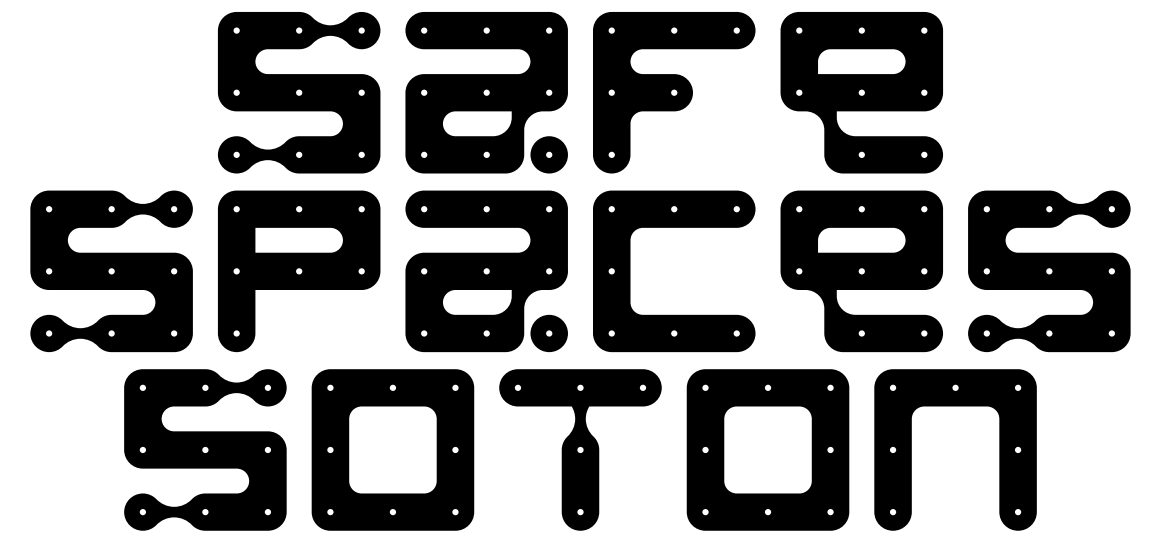

About Activity.

These photographs have been taken by Luke Shears and you can see more on our website. These capture a glimpse of different spaces within a short walk along Southampton’s Northam Road. You can use these to start a conversation locally.

This pack contains:

- . Examples of how local communities have humanised their unused public spaces.
- . A description of some forgotten space locations along the Northam Road.
- . Images which explain the complicated and changing history of the Northam Road area.
- . An example of how you can visually create and share your space changing ideas.
- . Some lightly illustrated drawings of the Northam Road spaces onto which you can collage, write or draw your space changing ideas.



2. Landscaped green spaces around the Six Dials underpass. These unloved benches face a large circular unused area of grass. The space is adjacent to housing and many people pass by en route to the underpass.



5. This space at the old Northam Methodist Church, corner Union Road and Northam Road. Grass area and tarmac with tree alongside pavement. Metal fencing at the road crossing which leads to Northam Estate. The tarmac area is often abused with flytipping.



6. This park between Union Rd and Summers Street was landscaped with a playground in the 1970s. The tarmac areas now lay empty but the park's trees are now mature.

1. The Six Dials underpass is a warren of foot tunnels with some open spaces. There are low walls with evergreen shrubbery and some tiled walls with graffiti. This space; the most open area within the underpass has a circular brick feature with three exit points.

3. An elongated roadside verge holds traffic facing electronic billboards at either end. The walled space is adjacent to a busy Northam Road bus stop.



4. This wide paved area at the corner of Northam estate faces the main road. To its side is a popular bus stop and the entrance to the Northam estate empty presinct.



NORTHAM ROAD

AREA HISTORY

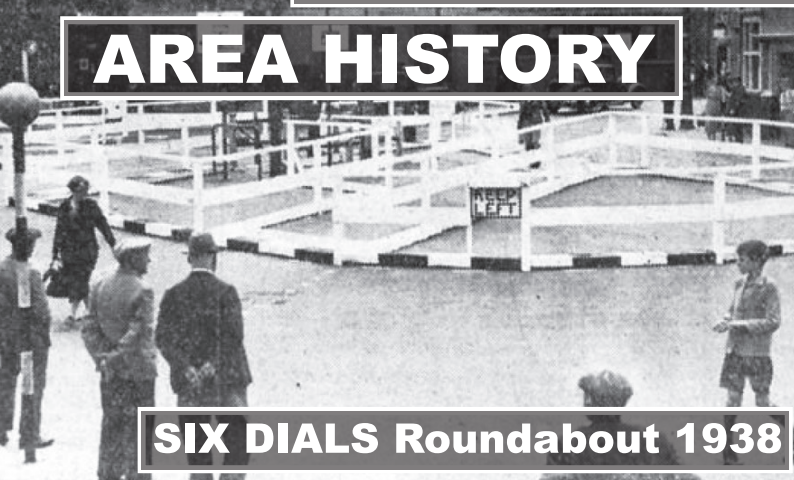

SIX DIALS Roundabout 1938



PLAZA CINEMA



Cinema demolished, replaced by Television Studios, also small landscaped park and playground.



Houses in front of Methodist Church demolished for road widening

SIX DIALS

This comparison illustrates how a once connected community has been separated over time by an ever widening road. The road is now littered along its entire fringe with forgotten spaces and neglected connecting pathways.

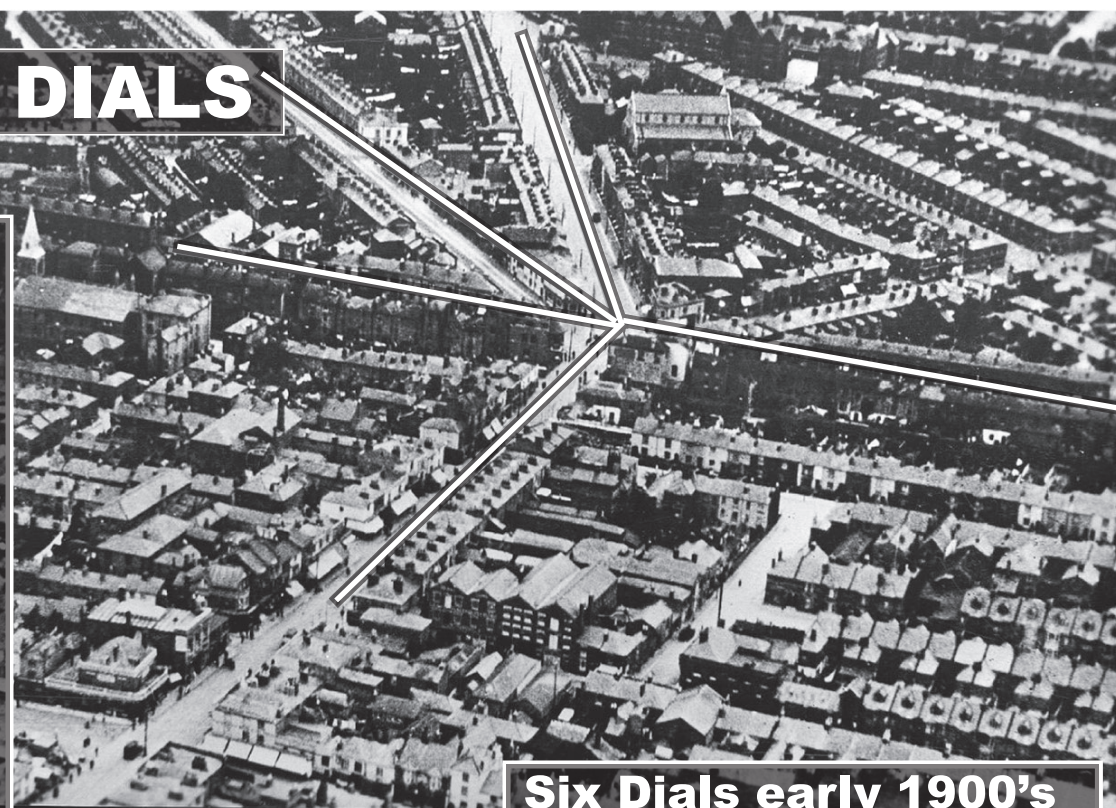

Six Dials early 1900's and below current day.

Northam Gas Holders

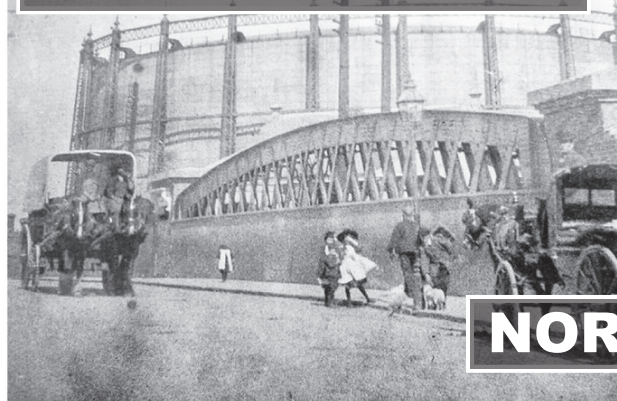

NORTHAM ESTATE

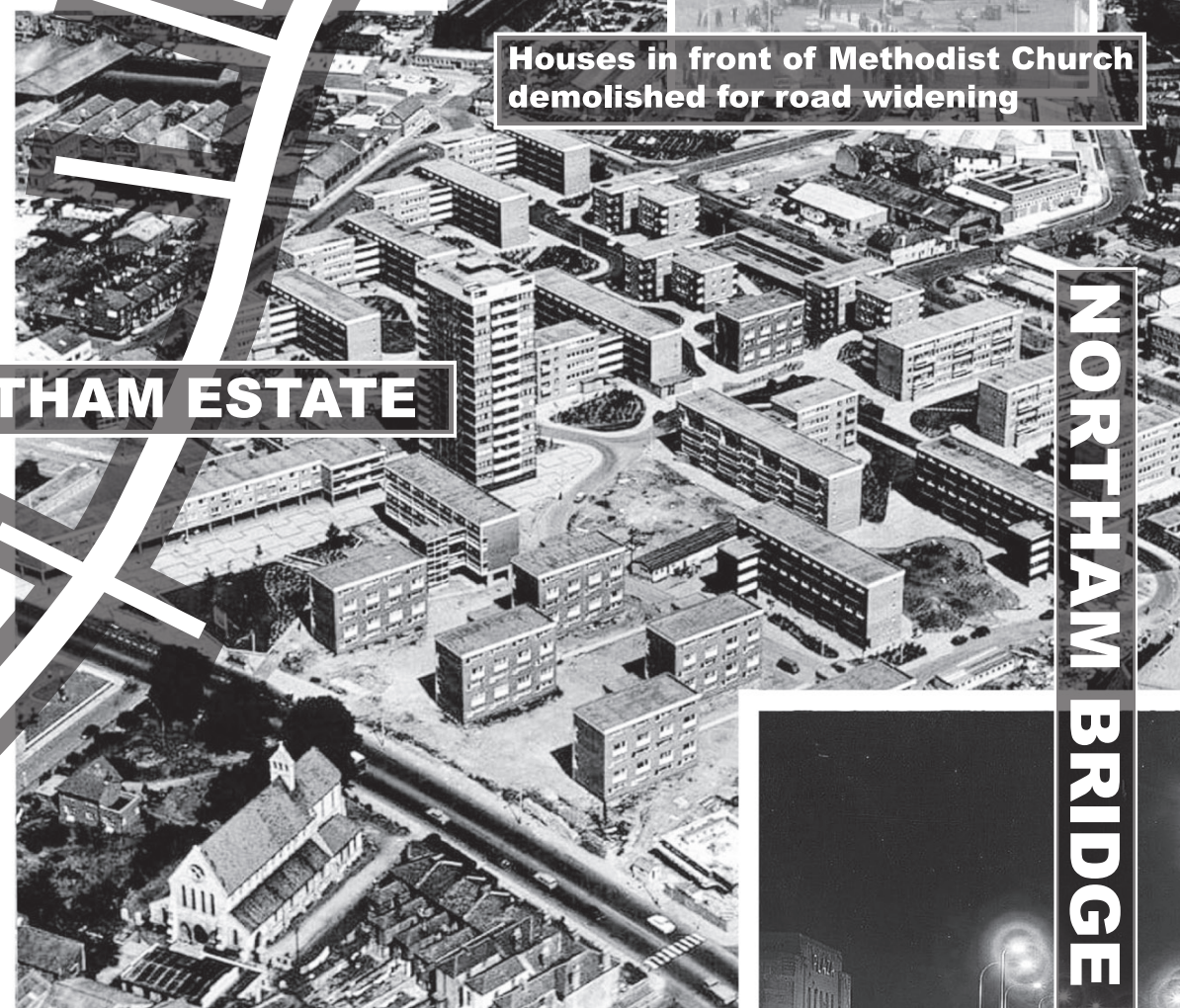

NORTHAM BRIDGE

Anglo Saxon Hamwic excavations

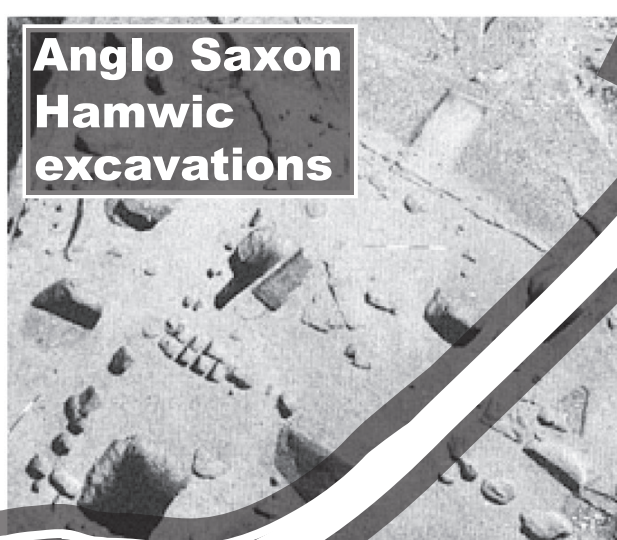

Six Dials underpass construction.

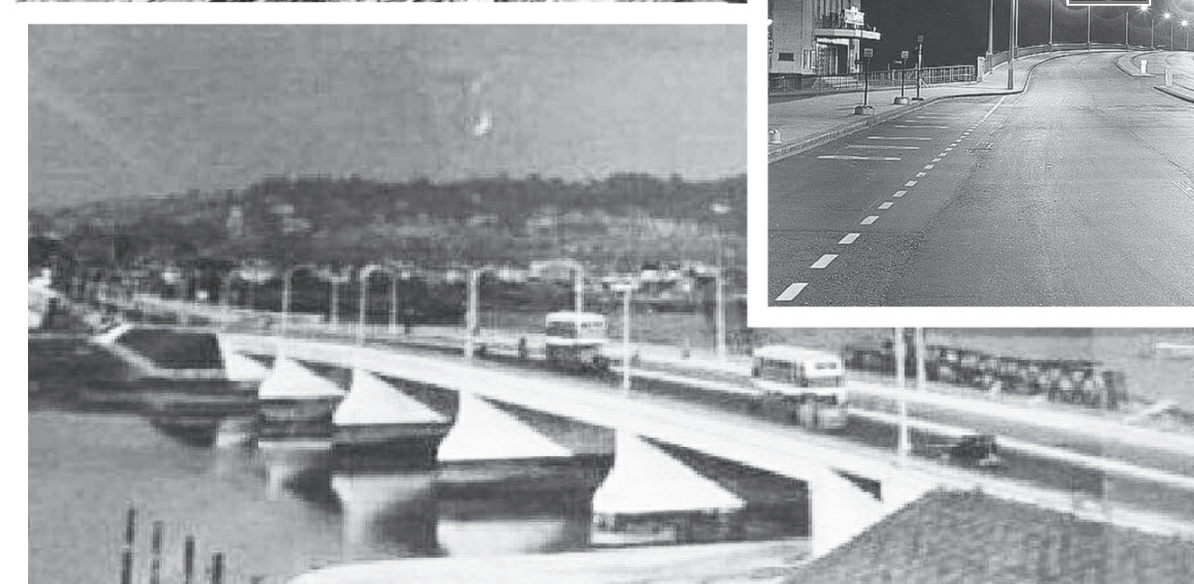
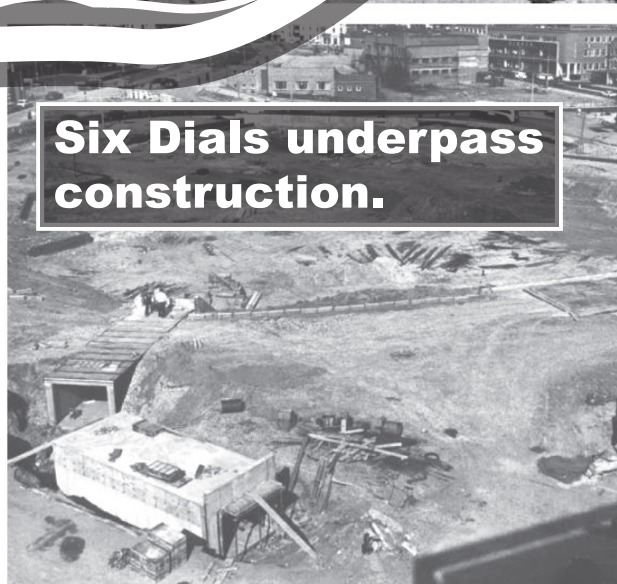



Skate Southampton is a voluntary organisation which aims to promote skateboarding as a creative, yet accessible culture. It provides support to individual skate-related creative projects and those promoting inclusive cultural activities. It believes in the promotion and construction of skateparks and supportive infrastructure and so strives to collaborate with councils, communities, companies and charities.



Skateboarding is naturally an all-embracing activity where the thread of inclusion comes from a common love of skateboarding.

Skateboarders often find sanctuary from problems in their lives in the act of skating and from its supportive culture. This culture is often located at a known skateboarding space, often a civic space or abandoned space re-purposed by skateboarders.

There are unwritten codes within the culture regarding these shared spaces, the main one being 'all are welcome'. This purely natural, yet crucial, code allows for and encourages individualism, cohesion and proactive actions towards the creation of an inspiring, safe, shared sanctuary.

What to do;

This pack contains a variety examples of spaces along the Northam Road for which you could create space transformative ideas.

You can simply write, draw or collage onto the space location plans or the simple line drawings provided in this pack.

You could also take photographs of other spaces in your community which you think could be transformed.

Again, it's up to you how you want to visualise and communicate your ideas.

From writing to drawing to painting to collage or even model building, these are all great ways to visualise and share your ideas.

Share your visions;

@SafeSpaceSoton on Instagram
#SafeSpacesSoton or #JHGCommunity



Example;





A rectangular area with horizontal lines for writing, intended for a description of the scene.

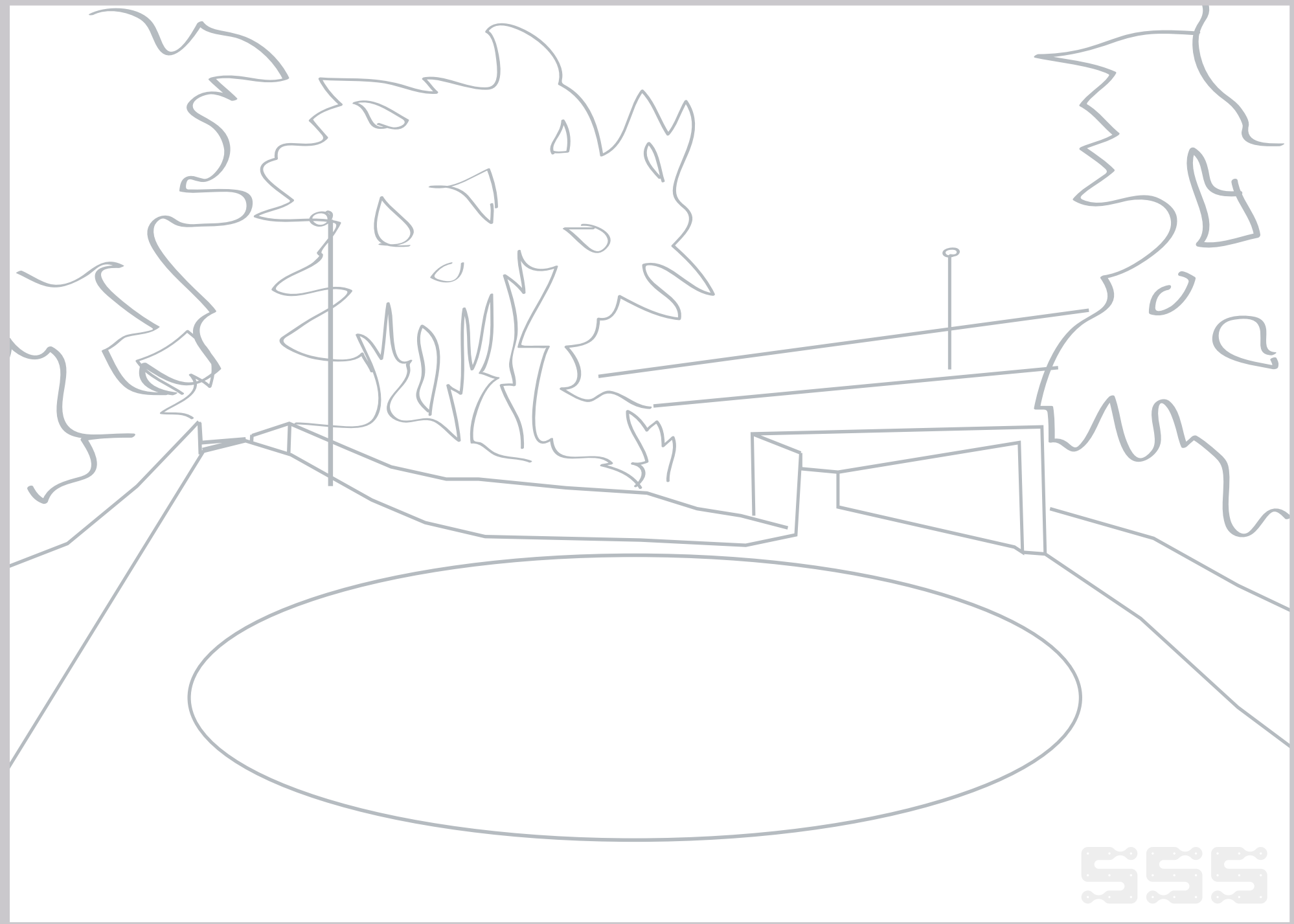
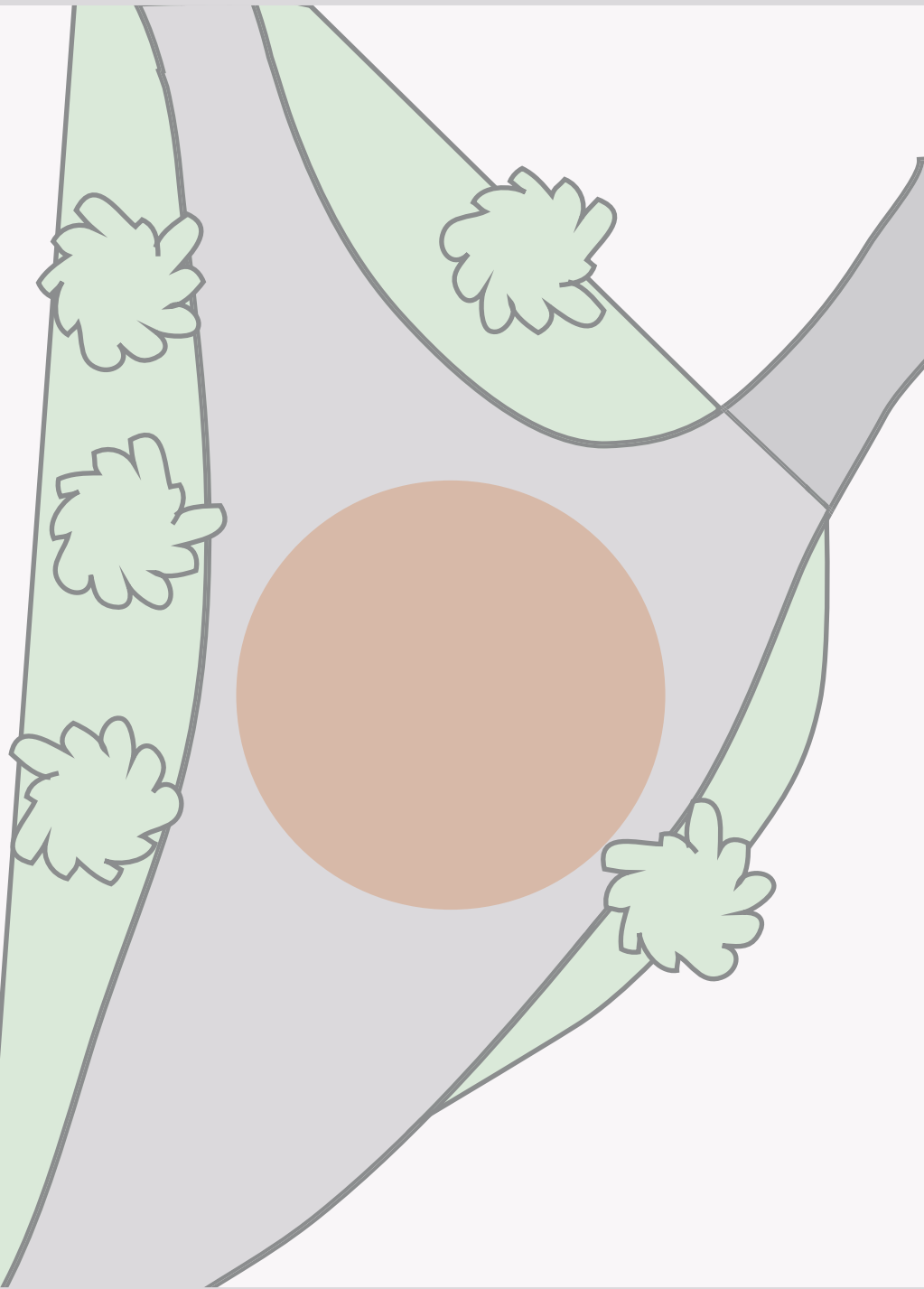



A blank sheet of lined paper with horizontal ruling lines, intended for writing notes or observations.

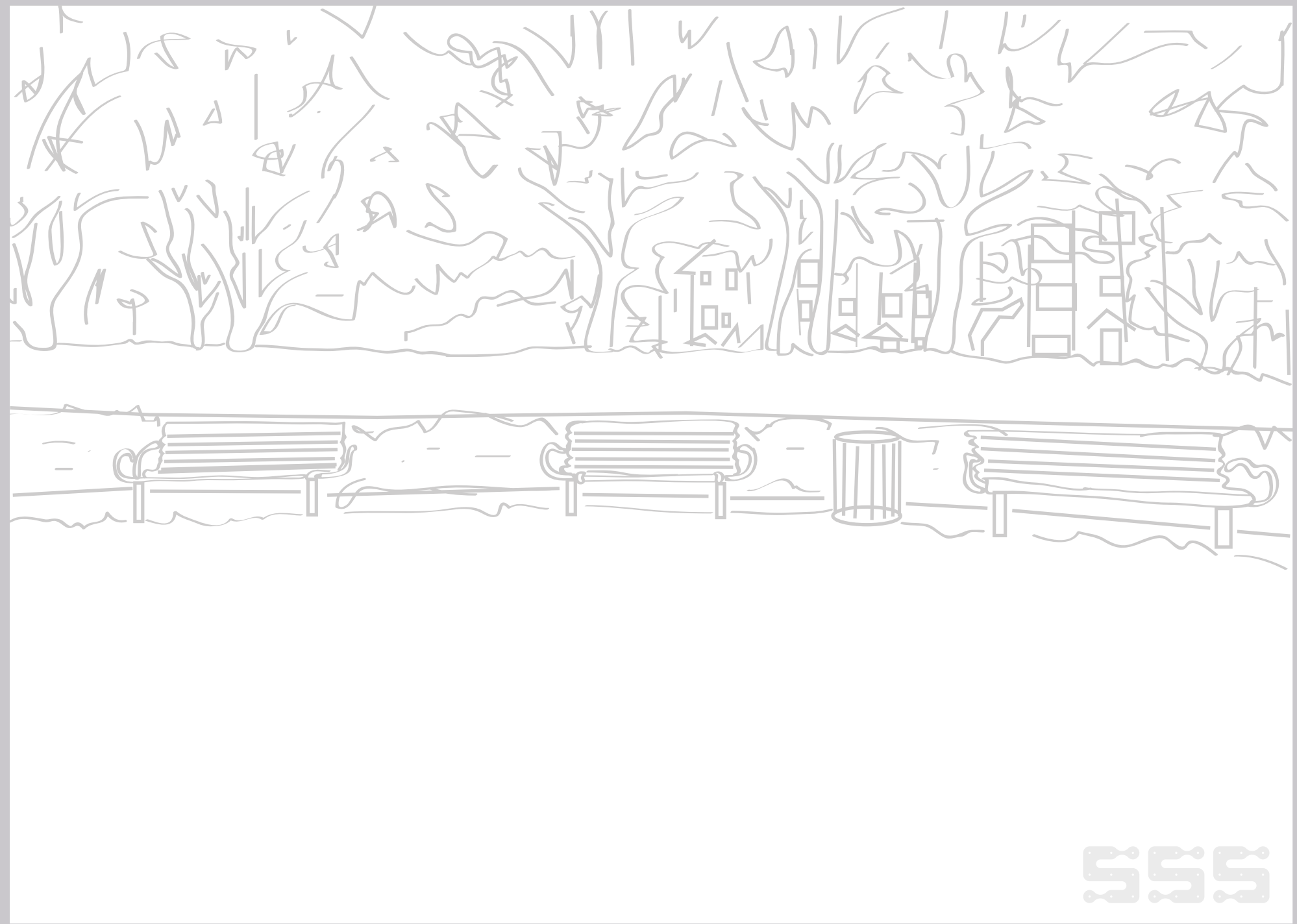
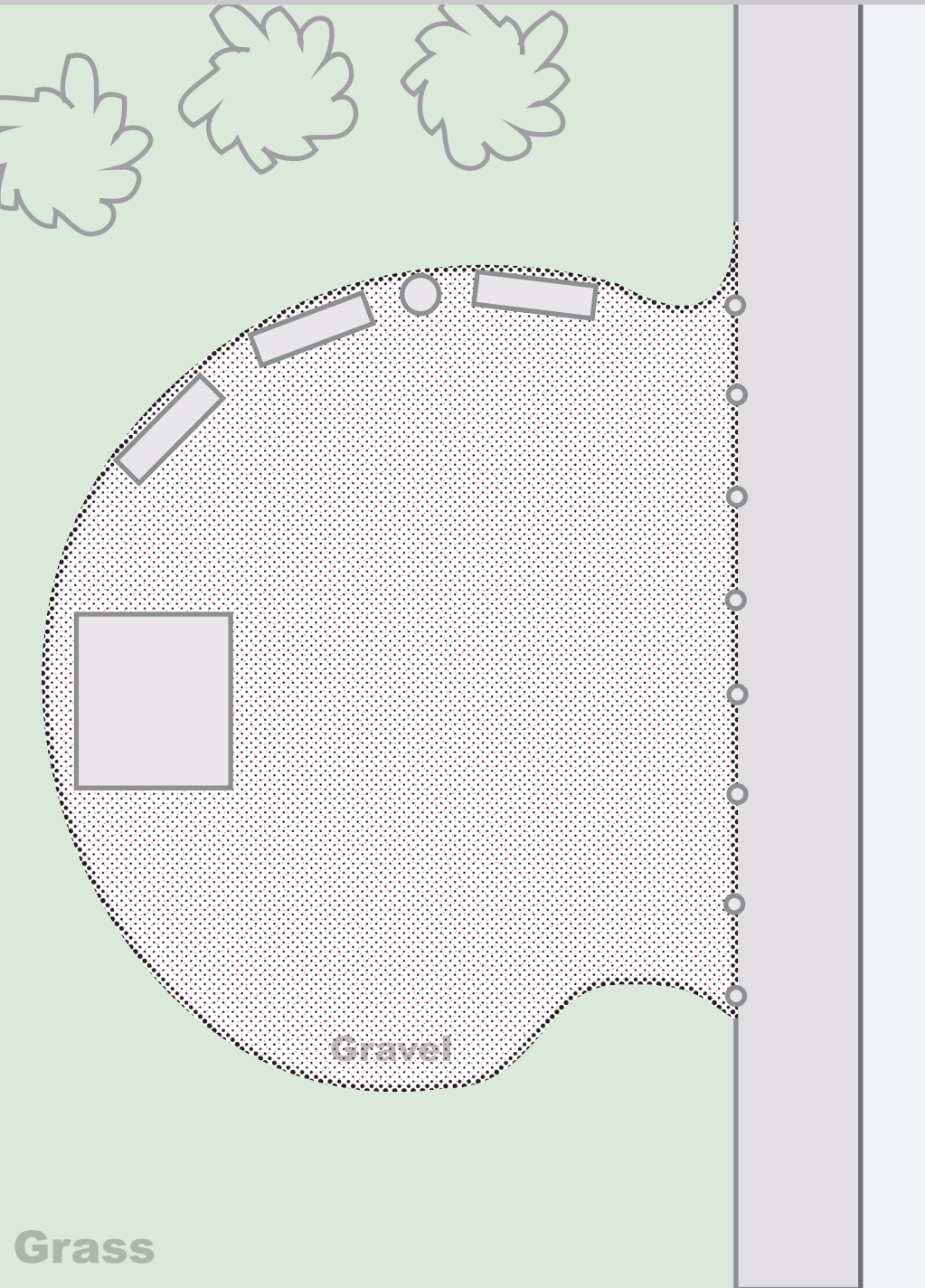

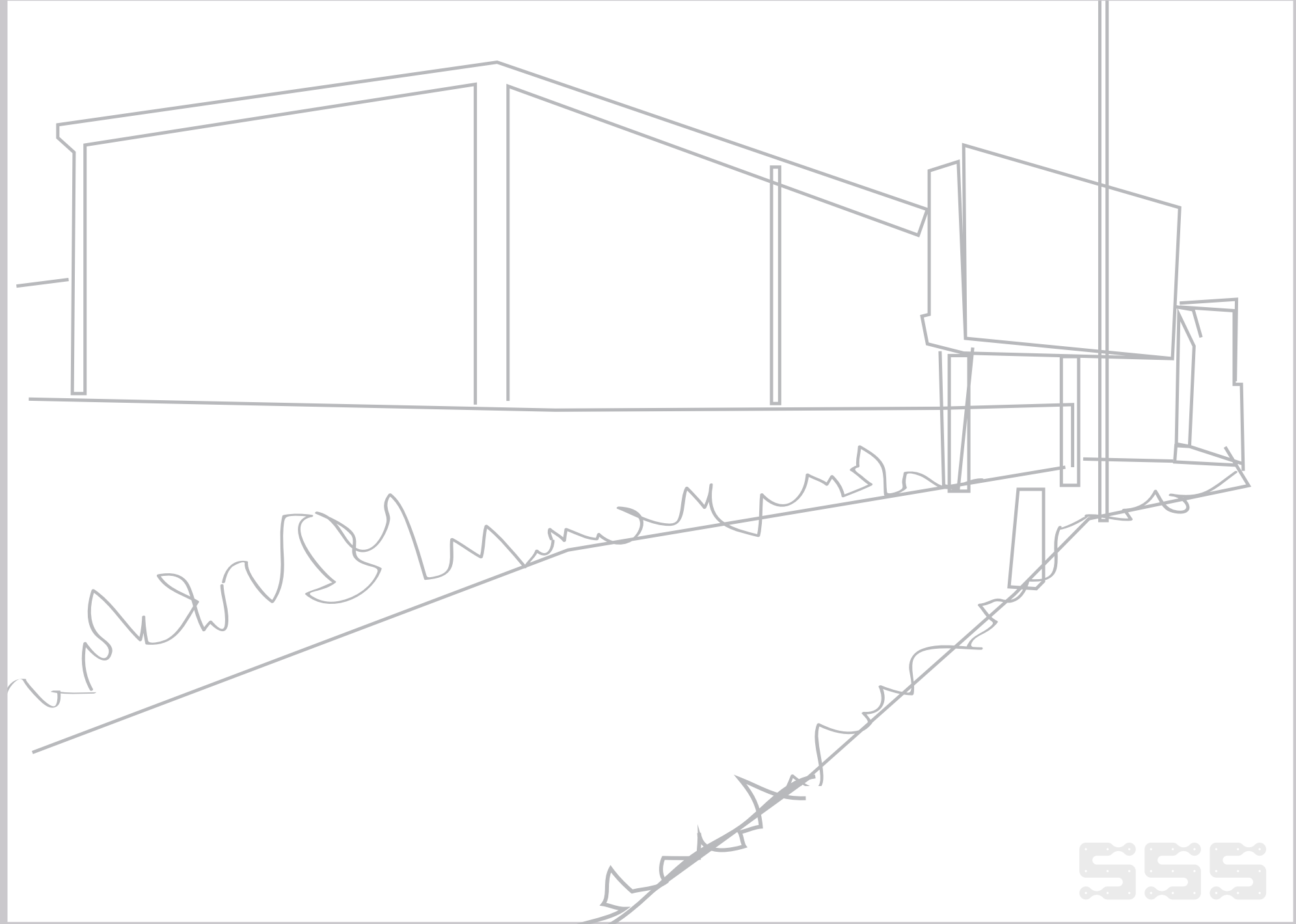
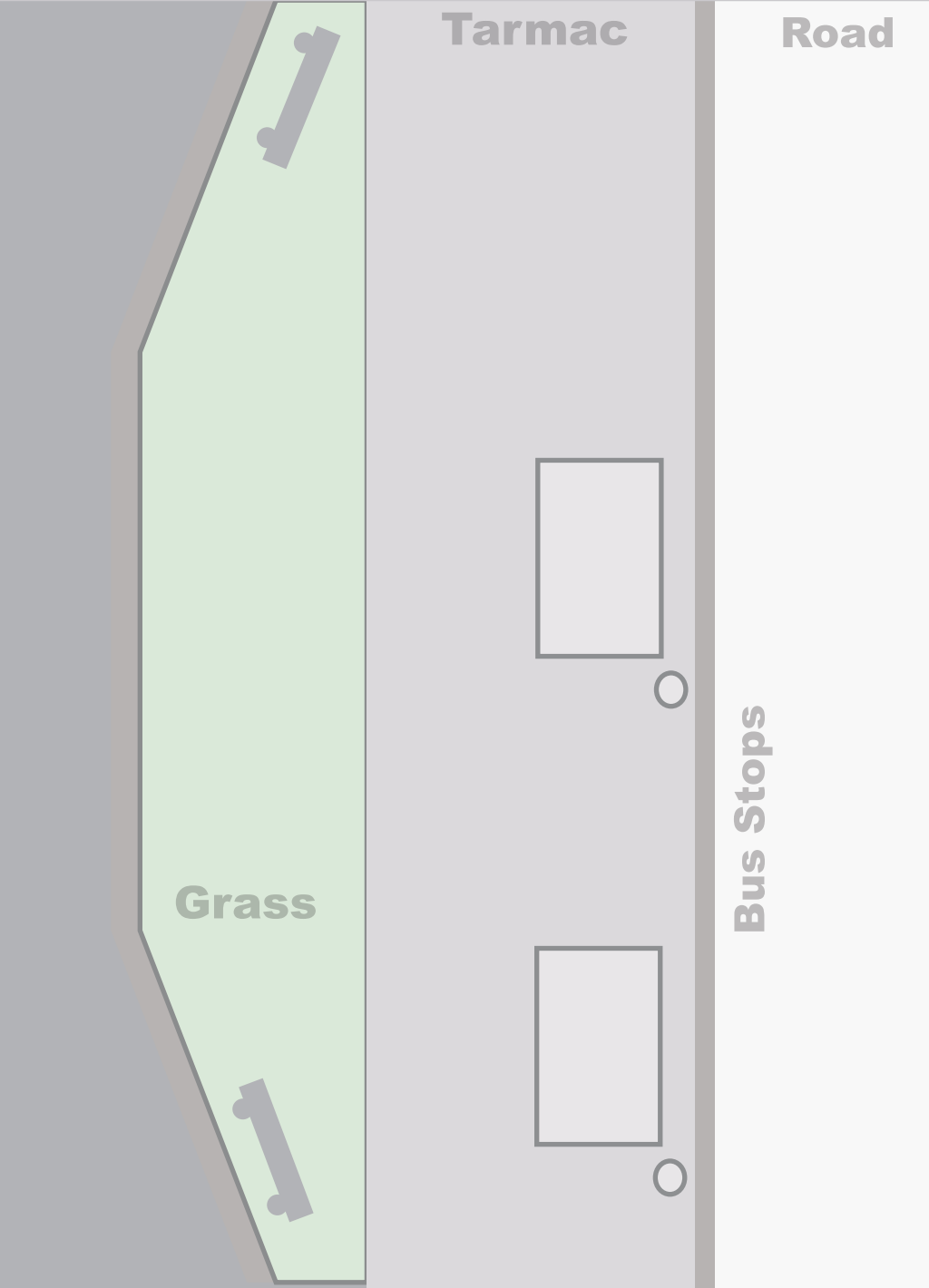
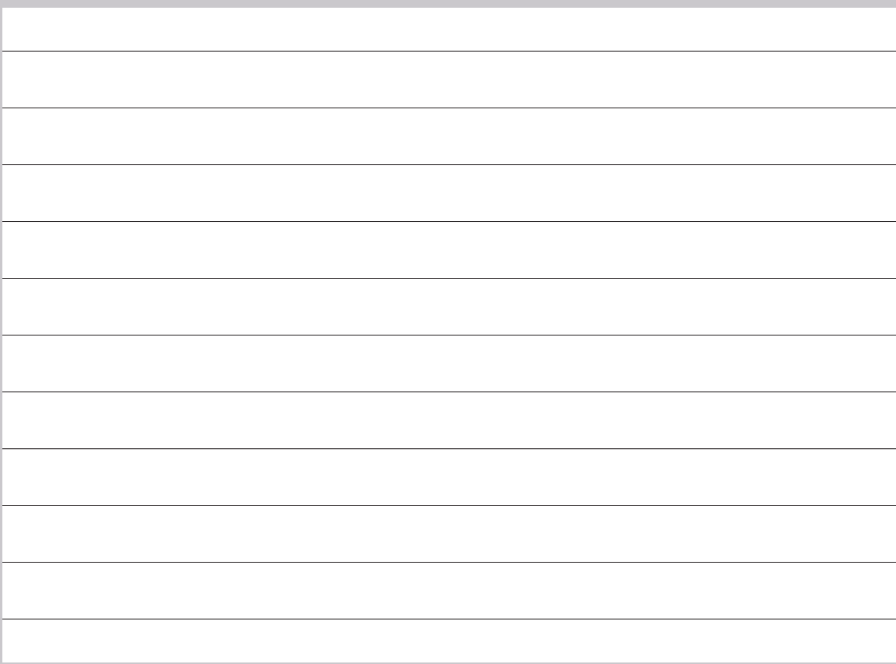

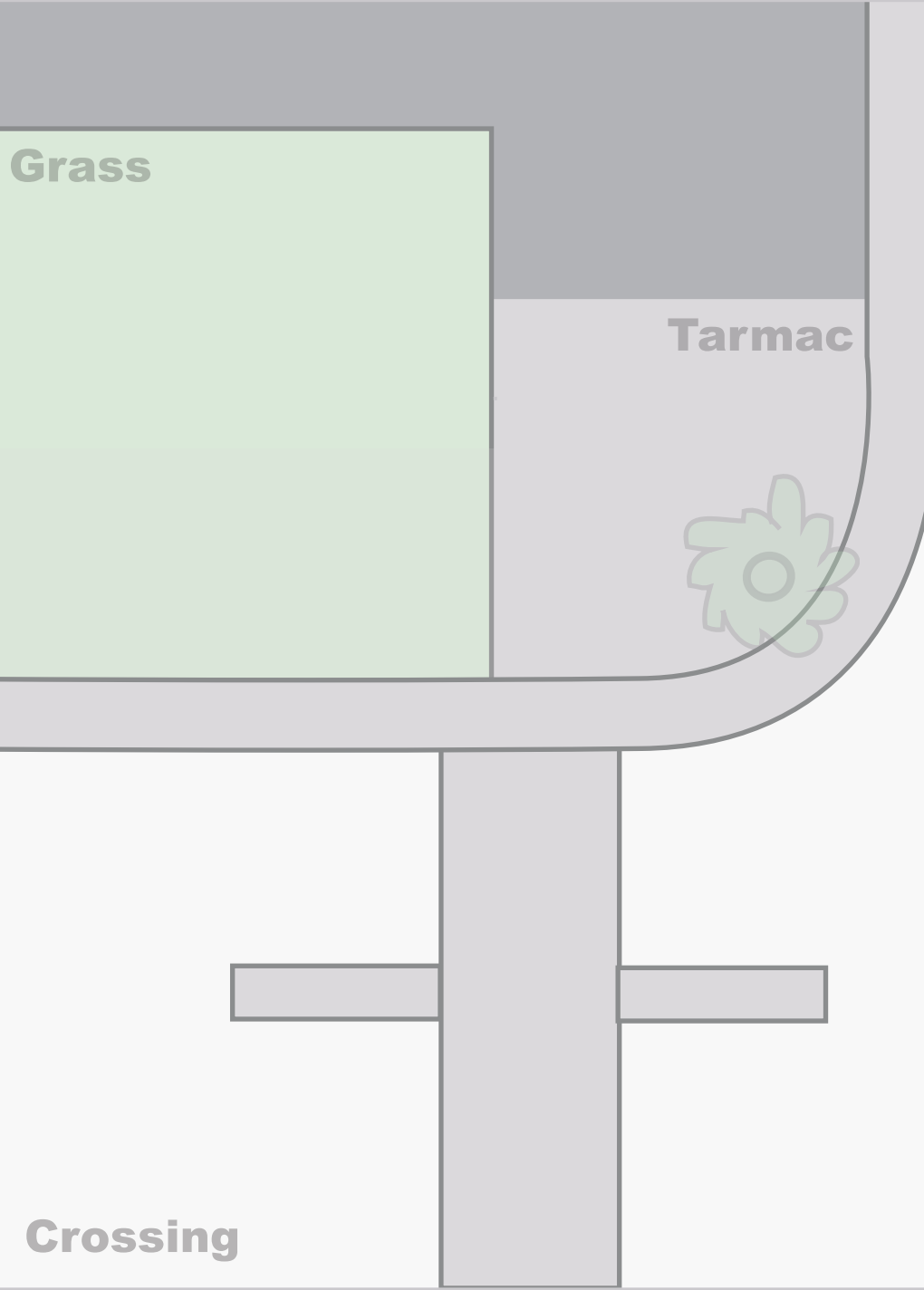
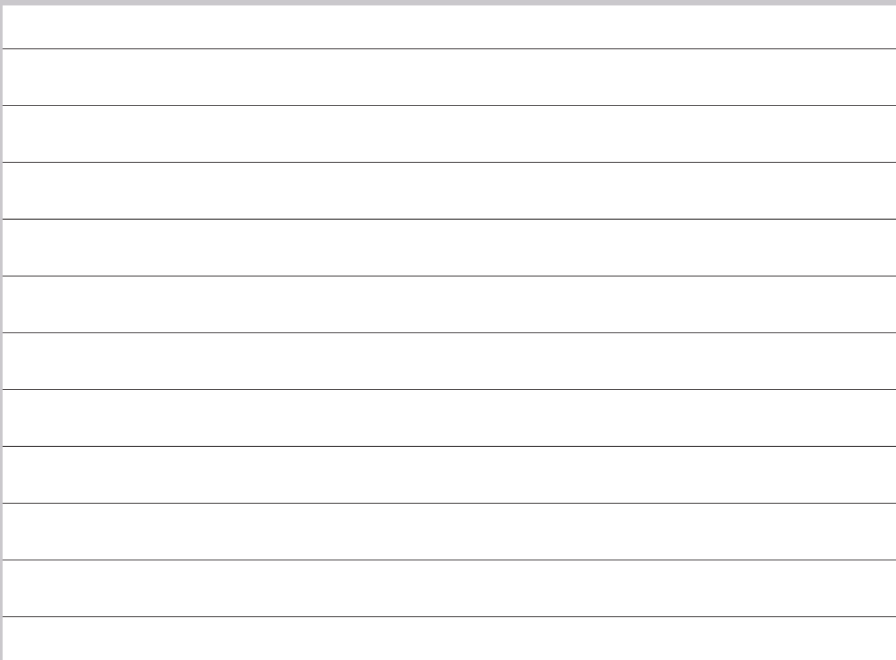



A series of horizontal lines for writing, consisting of 12 lines.

